

NOTICE

The purchaser agrees when purchasing this plan (the "Plan") that the purchaser has acquired the right to build or construct the object or project set out in the Plan (the "Project") for his/her/its personal use only and not for any reproduction of the Plan in whole or in part by any means whatsoever is strictly prohibited.
 2) Reproduction of the Plan in whole or in part by any means whatsoever shall not be liable for any copyright infringement or trademark violation. The Project or any tools used to construct the Project or for any loss or damage resulting therefrom.

NOTE: Read all instructions before beginning.
 Dimensions shown in brackets denote millimeters
 Set all nails and countersink all screws

Directions

1) Lay out your material as outlined in the material layout & cutting diagram (Fig 1 & 2). Draw out all parts exactly as illustrated, including the letter designations. In pencil. Ensure to leave a small space between cut lines to allow for the width of the saw. Before cutting, double check all measurements to ensure they are correct. Midways cut on the waste side of the line. The directions are for a 48" door slope. However, the door slope can be adjusted from 45 to 90 degrees for pieces B, P & J and the dowel running between them. For example, if your closet is 95", piece B will be 47" long, piece J 45", 1 1/2", and the dowel 47". For a six foot closet we have taken 12" off B and J, and 12" off A and K. For a four foot closet we have removed A and K entirely.

2) For most closets you will have to make each shelving component and do the final assembly in the closet. When attaching the ends of your shelves supports to the wall, have someone hold the shelf support in place while you attach it. Either screw the shelf supports into the studs in your wall, or use drywall anchors.

3) Lay out pieces D as shown (Fig 3) and drill the sixty holes using a depth gauge (illustration 1) with a 1/4" dia. drill bit, to a depth of 3/8" (Assuming your shelf support brackets are 1 1/4" dia.). Drill the 1 1/4" hole in pieces Q as shown (Fig 4) (not required if using closet rod). Glue and nail pieces L to pieces E as shown (Fig 5 & 6), remembering L is inset 1/2" from the edge of E. Nail with 1 1/4" finishing nails. Stand pieces D on their rear edges, glue and insert the EL assemblies between them and nail in place with 1 1/2" finishing nails. Remember to keep the holes drilled in D on the inside of this assembly. Stand this assembly up in position within the closet, ensure it is square, and allow to dry.

OVER

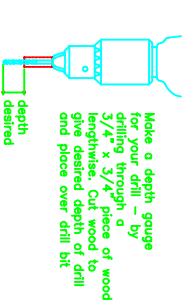

DRILL DEPTH GAUGE ILLUSTRATION 1

MATERIALS LAYOUT

FIGURE 1

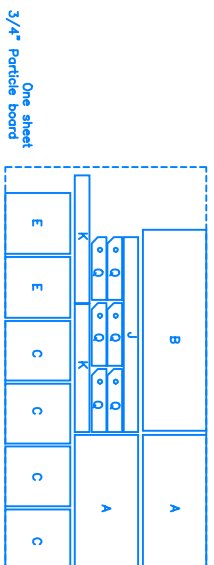
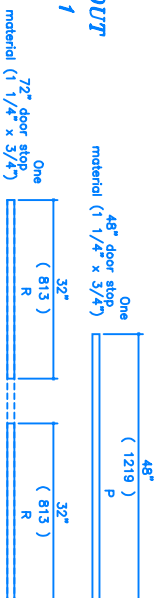

CUTTING DIAGRAM

FIGURE 2

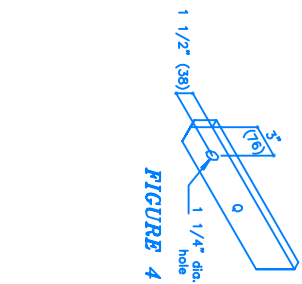

FIGURE 3

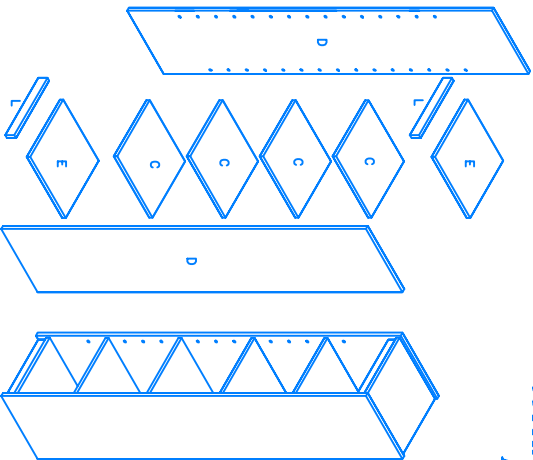
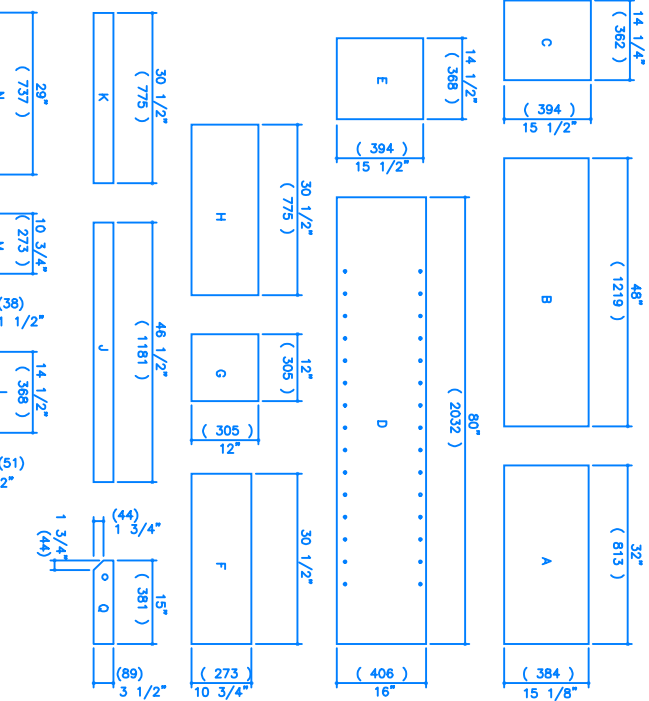

FIGURE 4

FIGURE 5



MATERIALS LIST

Two 3/4" 4x8' sheets particle board
 Approx. 1/2 lb. 1 1/4" finishing nails
 Approx. 1/2 lb. 1 1/2" finishing nails
 Approx. fifty #8 1 1/4" threaded screws
 Two 25" lengths 1 1/4" wood doweling*
 One 25" length 3/4" wood doweling*
 Three 6' doorstop (3/8"x1 1/4")

MATERIALS LIST

Sandpaper & Carpenters glue
 Sixteen shelf support brackets
 Wood putty
 Twenty one expansion shields
 * The expansion shields are replaced by adjustable closet rod

TOOLS

Table Saw and Migsaw
 Pencil and Measuring Tape
 1/16", 1/8", 1/4", 3/8", drill bits
 Hand and Skewers
 Paint Brush & Putty Knife